



# VV230

This diagram shows an exploded view of a mechanical assembly. The central component is a rectangular housing (1.1) with two large circular openings. To its left is a rectangular frame (1.15) with a grid of holes. To its right is another rectangular frame (1.19) with a grid of holes. Above the housing is a cylindrical component (1.12) with a flange. Below the housing is a flexible hose (3.1) with a flange (8.13) and a connector (8.9). Various other components are shown, including screws (1.19, 1.15), bolts (1.14, 1.12), and washers (1.10, 1.11). The parts are numbered 1.1 through 14.6, 1.15, 1.19, 3.1, 8.9, 8.10, 8.13, 10, 11.1, 11.2, 12, 13, 14.6, and 15.15.



## VV230

Assembly Drawing - Figure 2

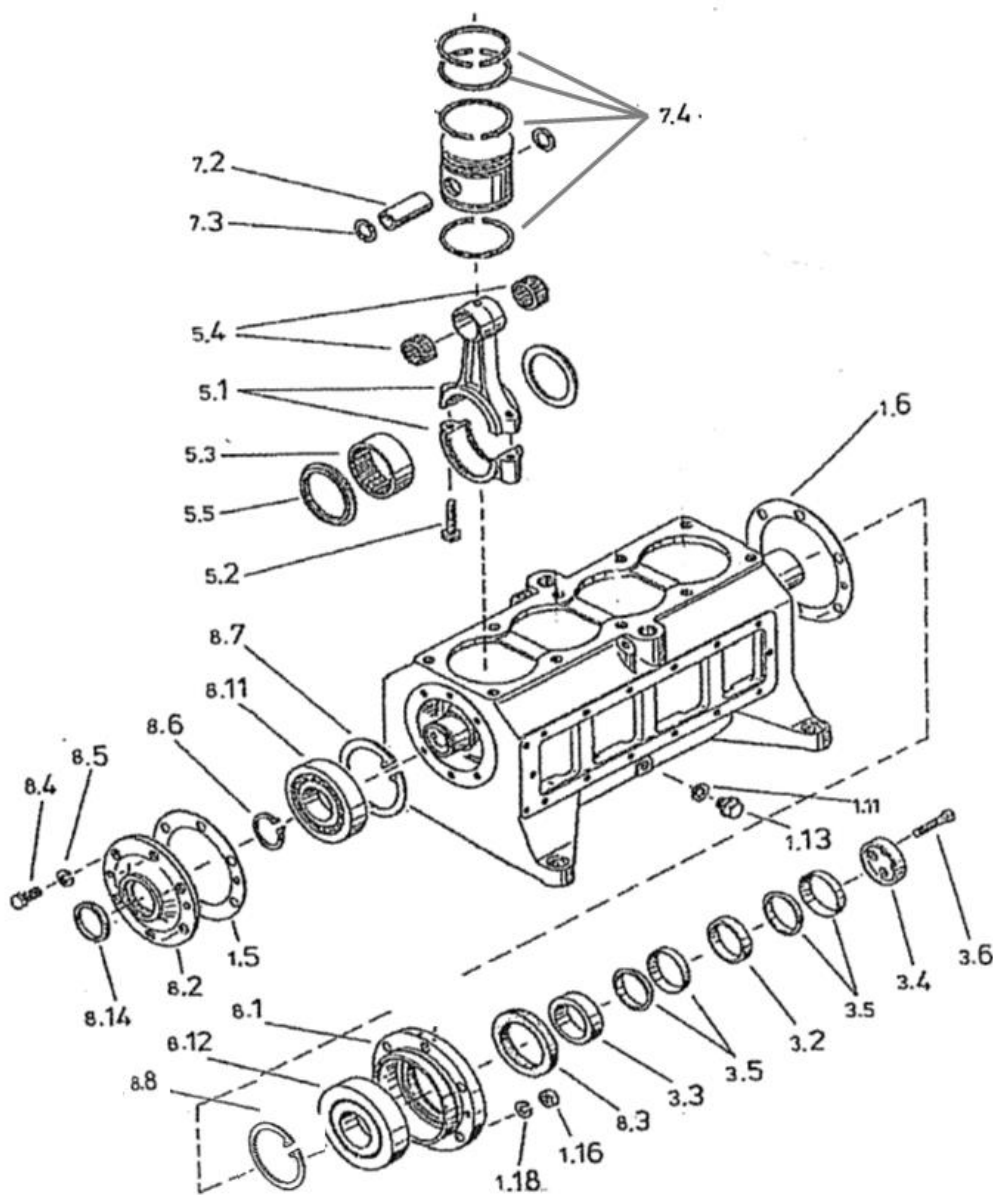



## VV230

Assembly Drawing - Figure 3

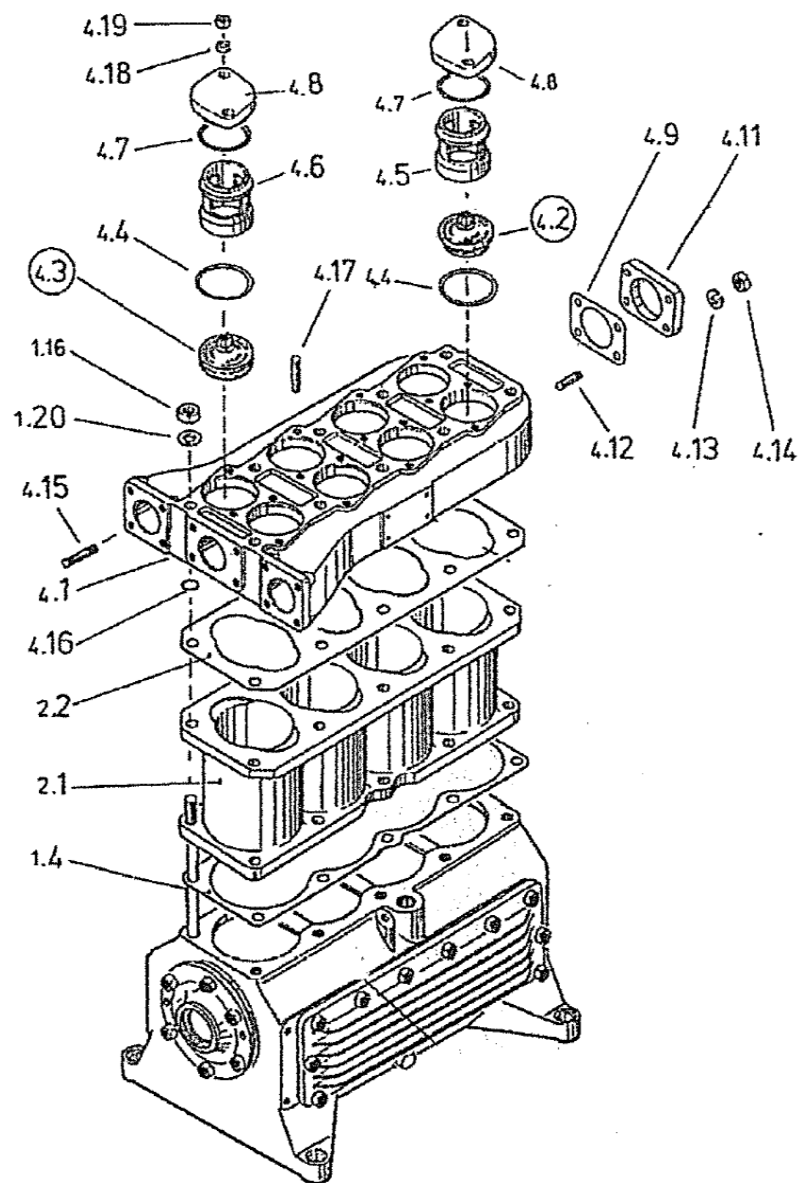



## VV230

Assembly Drawing - Figure 4

